

LUXLINE ACCENT 1515V

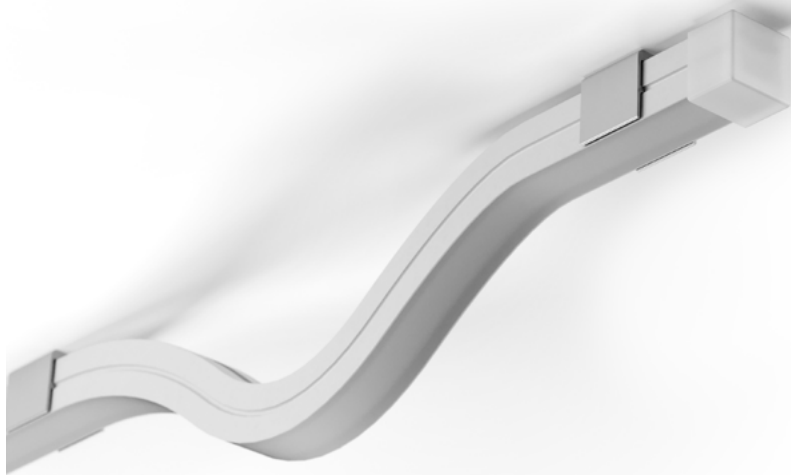

Scale 1:1



The **Luxline Accent 1515V** is a line voltage **120V** flexible silicone channel that bends up and down on the vertical axis. It provides a beautifully diffused uniform linear light. Designed to illuminate along curved surfaces. Resistant to water and UV light.

PRODUCT FEATURES

- Architectural grade
- High-quality silicone construction rated for outdoor use (IP65)
- 120VAC, 15x15mm, Vertical Bend
- Direct connection with line voltage and driver-free installation ensures added savings
- Integral fuse ensures overvoltage protection
- ETL certification for USA and Canada, conforms to UL STD 2388, certified to CSA STD C22.2#37
- Maximum run up to 164 feet
- Can be cut every 3"
- Available in three colour temperatures: 2700K, 3000K and 4000K at CRI 90+
- Patent-pending PowerUp-DC technology available for the unique benefits of 120VDC, including driverless, flicker-free dimming using various protocols (e.g. 0-10V, MLV, ELV, Triac) and high-voltage applications (120-277VAC range)

SUGGESTED APPLICATIONS

- bars
- shelving
- under cabinet
- displays
- toe kick
- cove

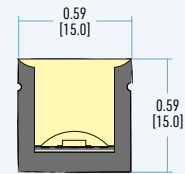

Scale 1:1

LENGTH PER ROLL CAN BE CUT EVERY

164 ft 50 m	3" 76 mm
----------------	-------------

CCT OPTIONS



CAUTION



LOCATION RATING



OTHER OPTIONS



dot-free

APPLICATION EXAMPLES



PARAMETERS

LED TAPE AND OPTICS CHART

@ FULL LIGHT OUTPUT

SMD2835	120V			
CCT range	2700K	3000K	3500K	4000K
Lumen output	215 lm/ft	224 lm/ft	233 lm/ft	237 lm/ft
Power	<4.3 W/ft <14.1 W/m			
Efficacy	50 lm/W	52 lm/W	54 lm/W	55 lm/W
CRI	90+			
LED tape increment	3 in 76 mm			
Max run	164 ft 50 m			
Quantity of LED chips	112 LED/m 34 LED/ft			

3000K

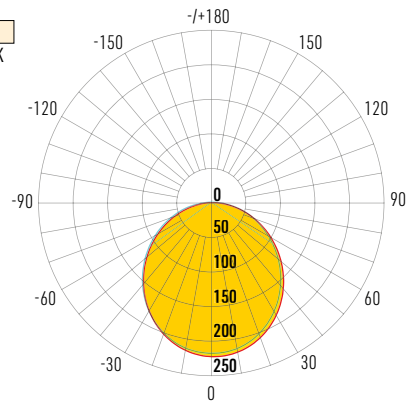

— CO/180, 109.2 Ic=222.8
— C90/270, 109.9 Ic=218.6

PROFILE DIMENSIONS

PROFILE

CL1515V

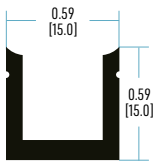

END CAPS

CLOSED

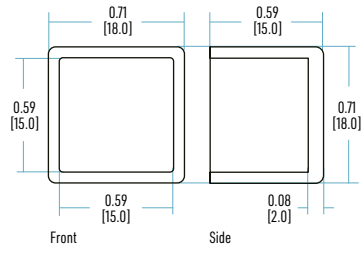

END FEED

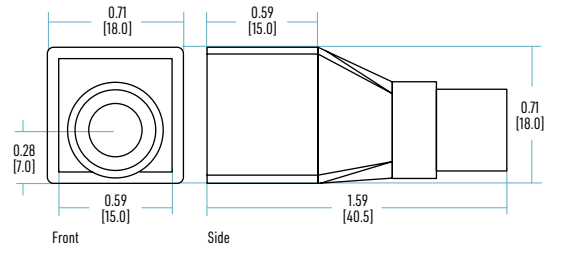

Scale 1:1

MOUNTING HARDWARE DIMENSIONS

MC1515V - FLAT BRACKET (alu.)

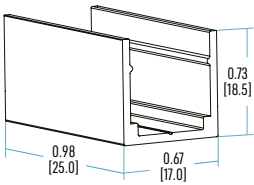

CR1515V - Mounting channel, rigid (aluminum) 1m

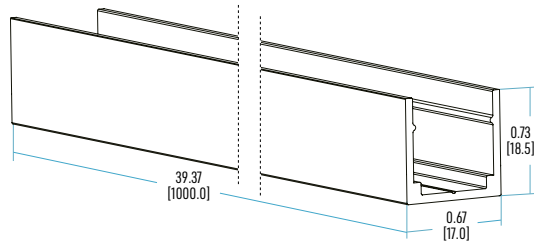

CF1515V - Mounting channel, flexible (aluminum) 1m

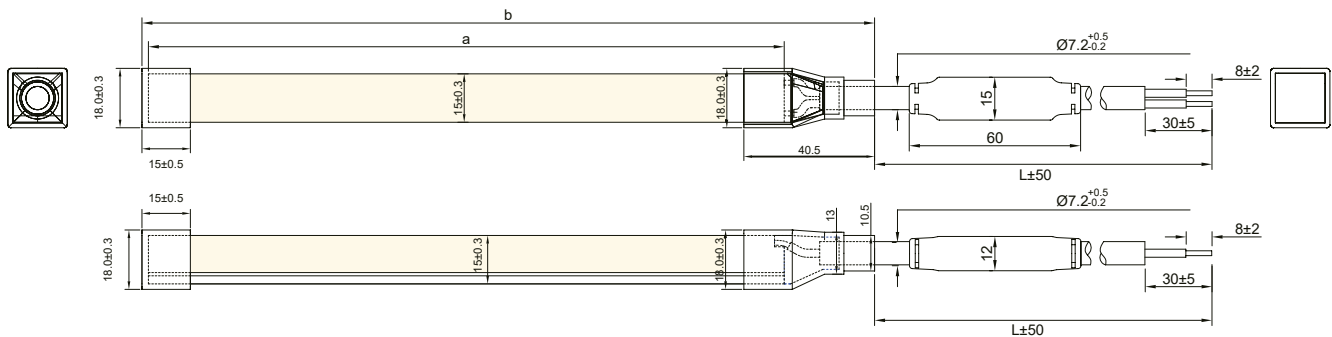
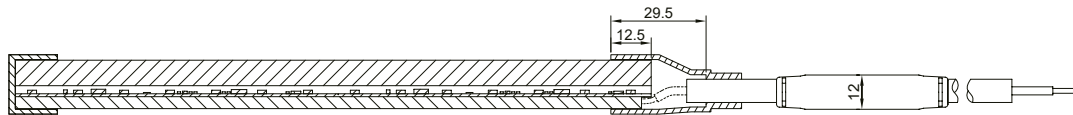
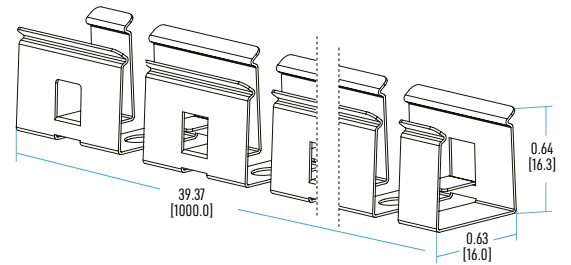

ORDERING SHEET

1 Channel	2 CCT	3 IP Rating	4 Power Feed	5 Input / Output	6 Exact / Optimal	7 Length, in	8 Voltage Hub
CL1515V		IP65			QO		

1 LED PLATFORM CL1515V - LuxLine Accent 15x15 Vertical Bend, 120V 4.3 W/ft	2 CCT 27 - 2700K 30 - 3000K 35 - 3500K 40 - 4000K	3 IP RATING IP65 - Outdoor rated, wet locations	4 POWER FEED FH3 - Hardwire, 3ft wire FHX - Hardwire, custom *(6"-35" / 15 cm - 90 cm)	6 INPUT / OUTPUT WSE - Simple lead-in, end feed WPE - Pass-through, end feed	6 EXACT/OPTIMAL QO - Optimal	7 LENGTH Increments of 3" (76.2mm) Max. run cannot exceed 164' (~50m)	8 VOLTAGE HUB PDC - PowerUP-DC PNO - No voltage hub
--	--	---	---	---	--	--	--

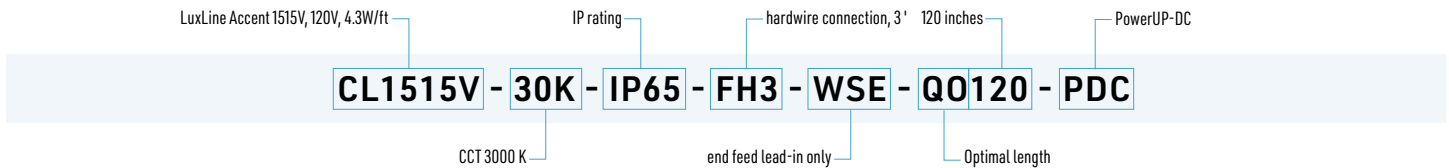

POWERUP-DC VOLTAGE HUB			
Product code	Power	LM-code	Quantity
LTL-200W-UNV-120V-PH010-BK	200W	lm42900-08	
LTL-400W-UNV-120V-PH010-BK	400W	lm42900-09	

ACCESSORIES			
Product code	Product description	LM-code	Quantity
MC1515V	Surface bracket	lm28997-18	
CR1515V	Rigid mounting channel	lm28997-19	
CF1515V	Flexible mounting channel	lm28997-20	
OEL15N	Silicone end cap	lm28997-16	

PRECISECUT

Precision Cutting, Every Time.

Take your installation to the next level with our professional-grade shear cutter. Engineered for precision, this tool delivers clean, effortless cuts on both LED tape and silicone sleeves, ensuring a flawless finish. With an adjustable cutting angle, it offers flexibility for custom applications while maintaining accuracy. The perfect add-on for seamless lighting integration.

Quantity:

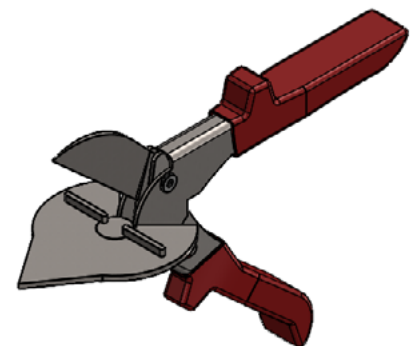

ELEVATING LED PERFORMANCE TO NEW HEIGHTS

Experience the next evolution in LED lighting with PowerUP-DC™ - an innovative voltage hub that unlocks the full potential of 120V DC technology. Designed for maximum efficiency, seamless dimming, and effortless integration, PowerUP-DC™ ensures superior performance in commercial and architectural applications.

Unique 120V DC benefits:

- **Universal Compatibility** - 120-277VAC input with 120V DC output
- **Flicker-Free Dimming** - supports multiple protocols, including 0-10V
- **Simplified Installation** - driverless DC control reduces costs and complexity
- **Expanded Design Freedom** - more flexibility for long, uninterrupted runs

Exclusively compatible with LuxLine™ XT (500, 300) and LuxLine™ Accent (HB, VB).

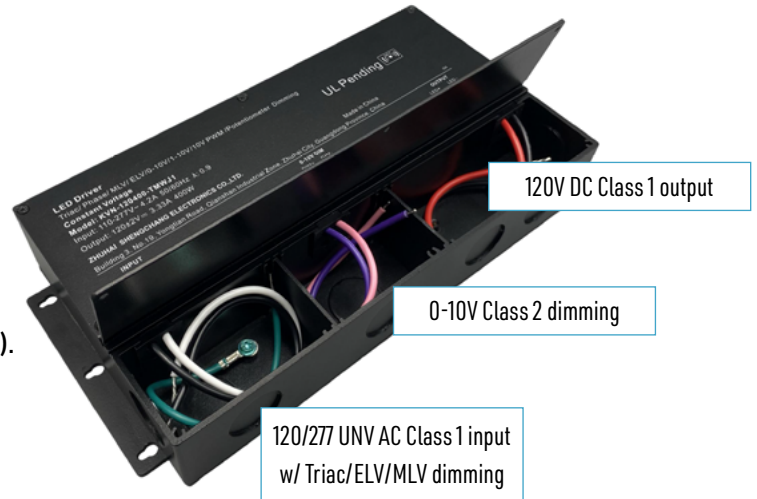

POWERUP-DC™

THE NEW DREAM TEAM FOR IMPROVED LED PERFORMANCE!

**ADVANCED LIGHTING TOOLS COMBINED WITH
PIONEERING TECHNOLOGY.**

**UPGRADE YOUR SETUP AND HIT THE JACKPOT WITH
LUXLINE & POWERUP-DC COMBO!**

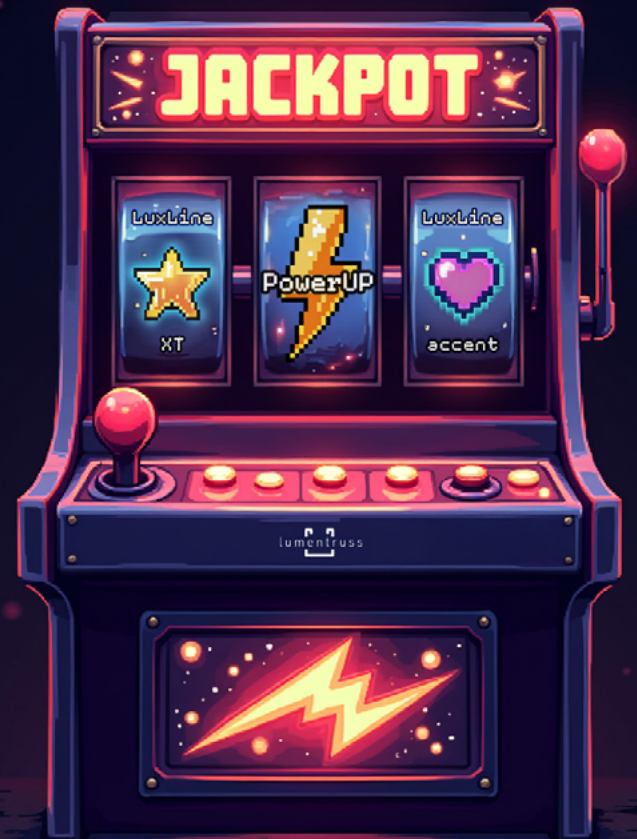

POWERUP-DC

PowerUP-DC		200W			400W		
Input	Voltage range	110-277VAC			110-277VAC		
	THD (Typ.)	≤6%@120V	≤8%@277VAC		≤20%@120V	≤20%@277V	
	AC Current (Max)	1.86A@120VAC	0.79A@277VAC		≤4.2A		
	Frequency range	47-63Hz			47-63Hz		
	Power Factor @ full load	0.99@120VAC	0.98@277VAC		≥0.98@120VAC	≥0.95@277VAC	
	Efficiency @ full load	92%@120VAC	95%@277VAC		≥92%@120VAC	≥94%@277VAC	
	Inrush Current (Typ.)	65A@50% Ipeak 208us @120VAC	102A@50% Ipeak 152us @277VAC		98A@50% Ipeak 660us @120VAC	102A@50% Ipeak 800us @277VAC	
	Leakage current	<0.5mA			<0.5mA		
Output	Dimming protocols	0-10V, ELV, MLV, Triac			0-10V, ELV, MLV, Triac		
	Load Regulation	±1%			±1%		
	Rated Current	1.67A			3.33A		
	Rated Power	200W			400W		
	DC Rated Voltage	120V			120V		
	Voltage Tolerance	±3%			±2%		
	Voltage Regulation	±1%			±0.5%		
Protection	Short Circuit	Shut down o/p voltage, recovers automatically after fault condition is removed			Hiccup mode, recover automatically after fault condition is removed		
	Over Load	≥110% constant current mode, automatically recover after the fault is removed			≤120% constant current or Hiccup mode, recovers automatically after fault condition is removed		
	Over Temperature	When the ambient temperature exceeds 55°C ±5°C, the output turns off. The ambient temperature drops to 45°C ±5°C, and the output is automatically resumed.			Shell surface temp.100 ±10 shut down o/p voltage, automatically recover after cooling.		
Environment	Operating Ambient Temperature	-40°C - +50°C			-40°C - +60°C		
	Working Humidity	20 - 95% RH non-condensing			20 - 95% RH non-condensing		
	Storage Temperature, Humidity	-40°C - +80°C, 10 - 95% RH non-condensing			-40°C - +80°C, 10 - 95% RH non-condensing		
	Temperature Coefficient	±0.02% / (0 - 50°C)			±0.03% / (0 - 50°C)		
	Vibration	10 - 500Hz, 56 12 minutes/cycle, X Y Z axis 72 minutes each			10 - 500Hz, 56 12 minutes/cycle, X Y Z axis 72 minutes each		
Safety & EMC	Safety Standards	UL8750 CAN/CSA-C22.2 No.250.13 (US)			UL8750 (US)		
	Withstand Voltage	I/P-FG:1.5KVAC US			I/P-FG:1.88KVAC (US)		
	Isolation resistance	non-isolated			I/P-O/P:100MΩ / 500VDC / 25 / 70%RH		
	EMC Emission	FCC Part15 Subpart B ANSI C63.4:2014 US			FCC Part 15, Subpart B; ANSI C63.4:2014 (US)		
Weight & Dimensions	Net Weight	1300g			1800g		
	Dimensions	207.4 x 116 x 40mm (L x W x H)			242 x 125 x 40mm (L x W x H)		
Compatible platforms Max run	LuxLineXT-500	436" (36.33')	11074.4mm (11.07m)	109 increments (4")	872" (72.66')	22148.8mm (22.15m)	218 increments(4")
	LuxLineXT-300	600" (50.00')	15240.0mm (15.24m)	150 increments (4")	1200" (100.00')	30480.0mm (30.48m)	300 increments(4")
	LuxLine Accent 1515V	558" (46.50')	14173.2mm (14.17m)	186 increments (3")	1116" (93.00')	28346.4mm (28.35m)	372 increments(3")
	LuxLine Accent 1220H	556" (46.33')	14122.4mm (14.12m)	139 increments (4")	1116" (93.00')	28346.4mm (28.35m)	279 increments(4")